

SCALE: 1 : 500



KEY NOTES

- 01 EXISTING TREES TO REMAIN
- 02 EXISTING SITE TREES TO BE REMOVED
- 03 EXISTING VEHICLE CROSSING TO BE DEMOLISHED
- 04 EXISTING CHORUS POLE TO BE REMOVED
- 05 PROPOSED VEHICLE CROSSING
- 06 PROPOSED COMMUNAL REFUSE AREA
- 07 PROPOSED COMMUNAL GREEN SPACE
- 08 PROPOSED COMMUNAL BIKE STORAGE AREA. REFER LANDSCAPE DESIGN
- 09 PROPOSED TIMBER RETAINING WALL

SHEET NOTES

- SITE SURVEY INFORMATION AS PROVIDED BY FRASER THOMAS LTD. (NOVEMBER 2024)
- SUBDIVISION AS PROVIDED BY FRASER THOMAS LTD. (AUGUST 2025)
- LOCATION OF NEW TRANSFORMER AS PROVIDED BY FRASER THOMAS LTD. (MARCH 2025)
- HEIGHT OF TRANSFORMER (1.2M ABOVE GROUND AT ADJACENT FOOTPATH) AND SWITCH (1.45M ABOVE GROUND AT ADJACENT FOOTPATH) AS MEASURED ON SITE BY FRASER THOMAS LTD. (MAY 2025)
- LANDSCAPE PLAN AS PROVIDED BY GREENWOOD ASSOCIATES (ARPL 2025)
- REFER TO LANDSCAPE PLAN FOR INDICATIVE LIGHTING LOCATION.
- REFER TO CIVIL INFRASTRUCTURE REPORT FOR PROPOSED SERVICES.
- LEVELS AND GRADIENTS SHOWN FOR REFERENCE. DRAWINGS TO BE READ IN CONJUNCTION WITH CIVIL ENGINEERING DOCUMENTATION.

LEGEND

- PROPERTY BOUNDARY
- PROPOSED EASEMENT
- YARD SETBACK
- OUTLOOK SPACE
- OUTLOOK INFRINGEMENT
- 2-BEDROOM DWELLING
- 3-BEDROOM DWELLING
- PROPOSED PAVED AREAS - REFER TO LANDSCAPE DESIGN
- TIMBER DECKING - REFER TO LANDSCAPE DESIGN
- PERMEABLE PAVING - REFER TO LANDSCAPE DESIGN
- PATIO PAVERS
- EXISTING PUBLIC STORMWATER
- EXISTING PUBLIC WASTEWATER
- PROPOSED STORMWATER LINE
- PROPOSED WASTEWATER LINE
- RUBBISH BINS ON PUBLIC COLLECTION DAY

Young+Richards+

4d Edwin St Mt Eden Auckland 1024 NZ +64 9 520 6444
120 Tennyson St Napier 4110 NZ +64 6 929 9945
info@youngrichards.com www.youngrichards.com



CLIENT
TRC - LARSEN & TORINO PN24

PROJECT ADDRESS
**170 TRIPOLI RD, 2-6 TUAKIRI ST, 51 KAWITI AVE
POINT ENGLAND
AUCKLAND 1072
PROJECT NUMBER
240216**

KEY PLAN

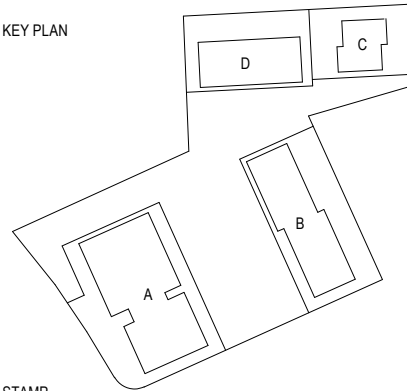

STAMP

THE FINE PRINT

- ALL WORK SHALL COMPLY WITH THE NZ RESOURCE MANAGEMENT ACT, NZ BUILDING ACT, RELEVANT STANDARDS, ORDINANCES, RULES, AND REGULATIONS OF THE TERRITORIAL AUTHORITY GOVERNING THE WORK. REFER TO NZ BUILDING ACT, SECTION 17.
- BUILDINGS NOT TO BE CONSTRUCTED, ALTERED, DEMOLISHED, OR REMOVED WITHOUT AN APPROVED AND VALID BUILDING CONSENT AND AN APPROVED AND VALID RESOURCE CONSENT WHERE APPLICABLE. REFER TO NZ BUILDING ACT, SECTION 40.
- FOR ALL RESTRICTED BUILDING WORK (RBW) THIS DRAWING IS NOT VALID FOR CONSTRUCTION UNLESS STAMPED BY THE RELEVANT BUILDING CONSENT AUTHORITY AS PART OF AN APPROVED AND VALID BUILDING CONSENT. CONSENTED DOCUMENTATION TAKES PRECEDENCE.
- FOR BUILDERS RESPONSIBILITIES REFER TO NZ BUILDING ACT, SECTION 14E.
- THIS DRAWING SHALL BE READ IN CONJUNCTION WITH ALL RELEVANT SPECIFICATION CLAUSES AND CONSULTANTS DOCUMENTATION.
- THE BUILDER IS EXPECTED TO VERIFY DIMENSIONS AND FIELD CONDITIONS AND CONFIRM THAT THE WORK CAN BE CONSTRUCTED AS DETAILED. REPORT OMISSIONS AND CONFLICTS WITHIN THE DOCUMENTS TO THE DESIGNER PRIOR TO PERFORMING ANY WORK IN QUESTION.
- DO NOT SCALE DRAWINGS. WRITTEN DIMENSIONS GOVERN. IN CASE OF CONFLICT, CONSULT THE DESIGNER.

© Young & Richards Ltd. 2025



SHEET NAME
SITE PLAN - GROUND FLOOR

PROJECT STATUS
RESOURCE CONSENT

SHEET SCALE **1 : 500** SHEET SIZE **A3=100%** PRINT IN COLOUR

SHEET NUMBER **A2-00-2200** REVISION **C**



KEY NOTES

- 01 PROPOSED COMMUNAL REFUSE AREA
- 02 PROPOSED COMMUNAL BIKE STORAGE AREA

SHEET NOTES

- SITE SURVEY INFORMATION AS PROVIDED BY FRASER THOMAS LTD. (NOVEMBER 2024)
- SUBDIVISION AS PROVIDED BY FRASER THOMAS LTD. (AUGUST 2025)



LEGEND

- PROPERTY BOUNDARY
- PROPOSED EASEMENT
- YARD SETBACK
- OUTLOOK SPACE
- OUTLOOK INFRINGEMENT
- 2-BEDROOM DWELLING
- 3-BEDROOM DWELLING

Young+Richards+

4d Edwin St Mt Eden Auckland 1024 NZ +64 9 520 6444
120 Tennyson St Napier 4110 NZ +64 6 929 9945
info@youngrichards.com www.youngrichards.com



CLIENT
TRC - LARSEN & TORINO PN24

PROJECT ADDRESS
**170 TRIPOLI RD, 2-6 TUAKIRI ST, 51 KAWITI AVE
POINT ENGLAND
AUCKLAND 1072**

PROJECT NUMBER
240216

KEY PLAN

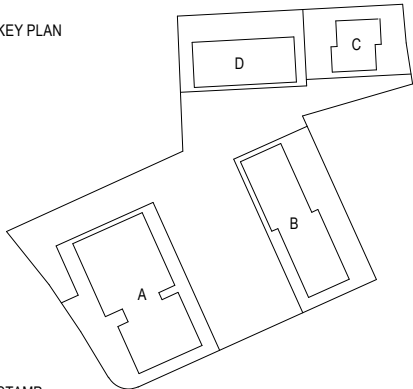

STAMP

THE FINE PRINT

- ALL WORK SHALL COMPLY WITH THE NZ RESOURCE MANAGEMENT ACT, NZ BUILDING ACT, RELEVANT STANDARDS, ORDINANCES, RULES, AND REGULATIONS OF THE TERRITORIAL AUTHORITY GOVERNING THE WORK. REFER TO NZ BUILDING ACT, SECTION 17.
- BUILDINGS NOT TO BE CONSTRUCTED, ALTERED, DEMOLISHED, OR REMOVED WITHOUT AN APPROVED AND VALID BUILDING CONSENT AND AN APPROVED AND VALID RESOURCE CONSENT WHERE APPLICABLE. REFER TO NZ BUILDING ACT, SECTION 40.
- FOR ALL RESTRICTED BUILDING WORK (RBW) THIS DRAWING IS NOT VALID FOR CONSTRUCTION UNLESS STAMPED BY THE RELEVANT BUILDING CONSENT AUTHORITY AS PART OF AN APPROVED AND VALID BUILDING CONSENT. CONSENTED DOCUMENTATION TAKES PRECEDENCE.
- FOR BUILDERS RESPONSIBILITIES REFER TO NZ BUILDING ACT, SECTION 14E.
- THIS DRAWING SHALL BE READ IN CONJUNCTION WITH ALL RELEVANT SPECIFICATION CLAUSES AND CONSULTANT'S DOCUMENTATION.
- THE BUILDER IS EXPECTED TO VERIFY DIMENSIONS AND FIELD CONDITIONS AND CONFIRM THAT THE WORK CAN BE CONSTRUCTED AS DETAILED. REPORT OMISSIONS AND CONFLICTS WITHIN THE DOCUMENTS TO THE DESIGNER PRIOR TO PERFORMING ANY WORK IN QUESTION.
- DO NOT SCALE DRAWINGS. WRITTEN DIMENSIONS GOVERN. IN CASE OF CONFLICT, CONSULT THE DESIGNER.

© Young & Richards Ltd. 2025



SHEET NAME
SITE PLAN - FIRST FLOOR

PROJECT STATUS
RESOURCE CONSENT

SHEET SCALE
1 : 500

SHEET SIZE
A3=100%

PRINT IN COLOUR

SHEET NUMBER
A2-00-2201

REVISION
C



- Existing tree to remain
 - Existing trees to remove
 - Specimen trees
 - Feature trees
 - Fruiting trees
 - Hedging
 - Climber
 - Large fill shrub/grass planting
 - Small shrub/grass planting
 - Standard concrete, bloom finish
 - Exposed aggregate concrete
 - Decking
 - Permeable patio pavers
 - Permeable pavers
 - Artificial turf
 - Washing lines
 - Wheelie bins
 - Wheelstops
 - Communal bin area
 - Sheltered communal bike storage
 - Shed
 - Landscape boulder
 - Picnic bench set
 - Gates
 - Fencing < 1.2m
 - Fencing > 1.2m
- SERVICES:**
- POTABLE WATER
 - STORM WATER
 - WASTE WATER
 - POWERLINES